

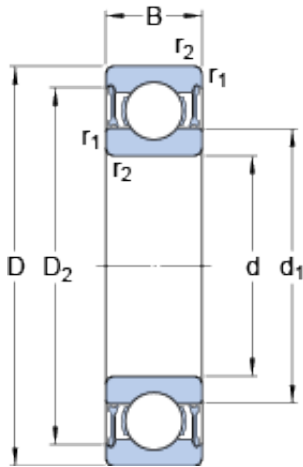

AMERICAN BEARING MFG.CORP.



25 mm x 52 mm x 15 mm SKF W 6205-2RZ
deep groove ball bearings

Bearing No. W 6205-2RZ

W 6205-2RZ Bearing 2D drawings and 3D CAD models

| | |
|---|-------------|
| Size | 52x25x15 mm |
| Bore Diameter | 52 mm |
| Outer Diameter | 25 mm |
| Width | 15 mm |
| d | 25 mm |
| D | 52 mm |
| B | 15 mm |
| d ₁ | 34 mm |
| D ₂ | 45.7 mm |
| r _{1,2} - min. | 1 mm |
| D _a - max. | 47 mm |
| r _a - max. | 1 mm |
| Basic dynamic load rating - C | 11.7 kN |
| Basic static load rating - C ₀ | 7.6 kN |
| Fatigue load limit - P _u | 0.335 kN |
| Reference speed | 30000 r/min |
| Limiting speed | 15000 r/min |
| Calculation factor - k _r | 0.03 |
| Calculation factor - f ₀ | 13.8 |
| d ₁ | 34 mm |
| D ₂ | 45.72 mm |
| r _{1,2} min. | 1 mm |
| d _a min. | 30 mm |
| d _a max. | 33.5 mm |



AMERICAN BEARING MFG.CORP.

| | |
|--------------------------------|----------|
| D_a max. | 47 mm |
| r_a max. | 1 mm |
| Basic dynamic load rating C | 11.7 kN |
| Basic static load rating C_0 | 7.65 kN |
| Fatigue load limit P_u | 0.335 kN |
| Calculation factor k_r | 0.03 |
| Calculation factor f_0 | 13.8 |
| Mass bearing | 0.13 kg |