

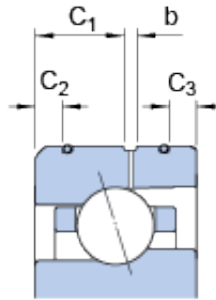

AMERICAN BEARING MFG.CORP.

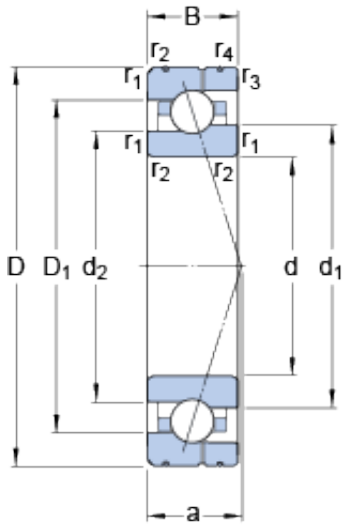

90 mm x 140 mm x 24 mm SKF 7018
ACE/P4AL angular contact ball bearings

Bearing No. 7018 ACE/P4AL

7018 ACE/P4AL Bearing 2D drawings and 3D CAD models

Size	140x90x24 mm
Bore Diameter	140 mm
Outer Diameter	90 mm
Width	24 mm
d	90 mm
D	140 mm
B	24 mm
d ₁	108.33 mm
d ₂	105.5 mm
D ₁	121.66 mm
b	2.6 mm
C ₁	13.2 mm
C ₂	4.3 mm
C ₃	4.3 mm
r _{1,2} - min.	1.5 mm
r _{3,4} - min.	1 mm
a	39 mm
d _a - min.	97 mm
d _b - min.	97 mm
D _a - max.	133 mm
D _b - max.	134.4 mm
r _a - max.	1.5 mm
r _b - max.	1 mm
d _n	111 mm



AMERICAN BEARING MFG.CORP.

Basic dynamic load rating - C	33.8 kN
Basic static load rating - C ₀	30 kN
Fatigue load limit - P _u	1.2 kN
Limiting speed for grease lubrication	12000 r/min
Limiting speed for oil lubrication	19000 mm/min
Ball - D _w	11.112 mm
Ball - z	28
G _{ref}	14 cm ³
Calculation factor - e	0.68
Calculation factor - Y ₂	0.87
Calculation factor - Y ₀	0.38
Calculation factor - X ₂	0.41
Calculation factor - Y ₁	0.92
Calculation factor - Y ₂	1.41
Calculation factor - Y ₀	0.76
Calculation factor - X ₂	0.67
Preload class A - G _A	300 N
Preload class B - G _B	920 N
Preload class C - G _C	1840 N
Calculation factor - f	1.1
Calculation factor - f ₁	0.99
Calculation factor - f _{2A}	1
Calculation factor - f _{2B}	1.03
Calculation factor - f _{2C}	1.06
Calculation factor - f _{HC}	1
Preload class A	196 N/micron
Preload class B	297 N/micron



AMERICAN BEARING MFG.CORP.

Preload class C	389 N/micron
d_1	108.33 mm
d_2	105.5 mm
D_1	121.66 mm
C_1	13.2 mm
C_2	4.3 mm
C_3	4.3 mm
$r_{1,2}$ min.	1.5 mm
$r_{3,4}$ min.	1 mm
d_a min.	97 mm
d_b min.	97 mm
D_a max.	133 mm
D_b max.	134.4 mm
r_a max.	1.5 mm
r_b max.	1 mm
d_n	111 mm
Basic dynamic load rating C	33.8 kN
Basic static load rating C_0	30 kN
Fatigue load limit P_u	1.2 kN
Attainable speed for grease lubrication	12000 r/min
Attainable speed for oil-air lubrication	19000 r/min
Ball diameter D_w	11.112 mm
Number of balls z	28
Reference grease quantity G_{ref}	14 cm ³
Preload class A G_A	300 N
Static axial stiffness, preload class A	196 N/ μ m
Preload class B G_B	920 N
Static axial stiffness, preload class B	297 N/ μ m
Preload class C G_C	1840 N



AMERICAN BEARING MFG.CORP.

Static axial stiffness, preload class C	389 N/ μ m
Calculation factor f	1.1
Calculation factor f_1	0.99
Calculation factor f_{2A}	1
Calculation factor f_{2B}	1.03
Calculation factor f_{2C}	1.06
Calculation factor f_{HC}	1
Calculation factor e	0.68
Calculation factor (single, tandem) Y_2	0.87
Calculation factor (single, tandem) Y_0	0.38
Calculation factor (single, tandem) X_2	0.41
Calculation factor (back-to-back, face-to-face) Y_1	0.92
Calculation factor (back-to-back, face-to-face) Y_2	1.41
Calculation factor (back-to-back, face-to-face) Y_0	0.76
Calculation factor (back-to-back, face-to-face) X_2	0.67
Mass bearing	1.2 kg