

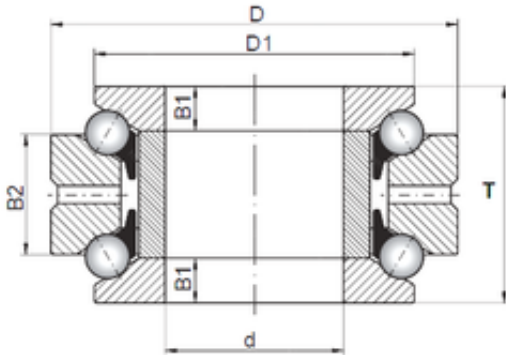

# AMERICAN BEARING MFG.CORP.

## ISO 234436 thrust ball bearings

Bearing No. 234436



Size	180x280x120 mm
Bore Diameter	180 mm
Outer Diameter	280 mm
Width	120 mm
d	180 mm
D	280 mm
T	120 mm
B1	30 mm
B2	60 mm
D1	248 mm

234436 Bearing 2D drawings and 3D CAD models